

# 2019 Parts Catalog

## Index By Part

Page 1

|  |       |
|--|-------|
| COMMERCIAL DAMPER CONTROL SWITCHES                     | 2     |
| COMPONENT PARTS FOR COMMERCIAL DAMPER CONTROL SWITCHES | 2     |
| NAVY DAMPER CONTROL SWITCHES                           | 3     |
| COMPONENT PARTS FOR NAVY DAMPER CONTROL SWITCHES       | 3     |
| NAVY BREAK GLASS STATION                               | 4     |
| NAVY BREAK GLASS STATION REPAIR KITS                   | 4     |
| DOOR HANDLES   | 4     |
| GAYLORD WATER SOLENOID VALVES AFTER 2006               | 5     |
| GAYLORD WATER SOLENOID COILS                           | 5     |
| GAYLORD WATER SOLENOID REPAIR KITS                     | 5     |
| GAYLORD WATER SOLENOID VALVES PRE 2006                 | 6     |
| GAYLORD WATER SOLENOID COILS PRE 2006                  | 6     |
| GAYLORD WATER SOLENOID VALVE NORMALLY OPEN             | 6     |
| BALL VALVES  | 7     |
| VACUUM BREAKERS  | 7     |
| VACUUM BREAKER REPAIR KITS                             | 7     |
| WATER CHECK VALVES                                     | 7     |
| BACKFLOW PREVENTERS                                    | 7     |
| LINE STRAINERS   | 7     |
| DETERGENT PUMPS  | 8     |
| DETERGENT PUMP PARTS                                   | 8     |
| PLUMBING CABINET PARTS                                 | 9     |
| C-7000A COMPLETE CONTROLS                              | 10    |
| C-7000A CIRCUIT BOARD                                  | 10    |
| C-6000C & C-6000D COMPLETE CONTROLS                    | 10    |
| C-6000D-ESP COMPLETE CONTROLS                          | 10    |
| GRC-5000 RETRO-FIT CONTROLS COMPLETE                   | 10    |
| C-6000B UPGRADE KITS                                   | 10    |
| AUTOSTART & DCA SYSTEM COMPONENTS                      | 11    |
| OPERATOR INTERFACES                                    | 11    |
| PLC'S  | 11    |
| C-6000 CONTROL PARTS                                   | 11    |
| C-200 CONTROL PARTS                                    | 12    |
| C-100 CONTROL PARTS                                    | 12    |
| UV & UVI COMPONENTS                                    | 13-14 |
| QUENCHER NOZZLES                                       | 15    |
| QUENCHER LINE STRAINERS                                | 15    |
| HOOD PENETRATION FITTINGS                              | 15    |
| QUENCHER MODEL QUA COMPONENTS                          | 16    |
| QUENCHER MODEL QUS COMPONENTS                          | 16    |
| QUENCHER MODEL QU COMPONENTS                           | 16    |
| QUENCHER PLUMBING COMPONENTS                           | 17    |
| QUENCHER CHROME FITTINGS                               | 17    |
| GAS SOLENOID VALVES                                    | 18    |
| GAS SOLENOID COILS                                     | 18    |
| GAS SOLENOID REPAIR KITS                               | 18    |
| VENTILATOR COMPONENT PARTS                             | 19    |
| VENTILATOR SPRAY NOZZLES                               | 19    |
| VENTILATOR THERMOSTATS                                 | 20    |
| VENTILATOR FUSE LINKS                                  | 20    |
| MI CABLE   | 21    |
| MI CABLE COMPONENTS                                    | 21    |
| FIRE SWITCHES  | 21    |
| FAST FOOD VENTILATOR PARTS                             | 22    |
| GX & GX2 EXTRACTOR CARTRIDGES                          | 22    |
| GREASE FILTERS   | 23    |
| XG & XGS EXTRACTORS                                    | 23    |
| HOOD LIGHTS  | 24    |
| HOOD LAMPS   | 24    |
| RSPC-ESP & RSPC-TPF COMPONENTS                         | 25    |
| RSPC FILTERS   | 26    |
| RSPC FM-100 COMPONENTS                                 | 27    |
| RSPC FM-1000 COMPONENTS                                | 27    |
| RSPC ODOR CONTROL PARTS                                | 27    |
| MMLAR FACEPLATES & PORON DISCS                         | 28    |
| EXHAUST DAMPERS  | 28    |
| ANEMOMETERS  | 28    |

**COMMERCIAL DAMPER CONTROL SWITCHES**

ALLOW 6-8 WEEKS FOR FABRICATION

PAGE 2

**IMPORTANT NOTE: Damper Control Switches for "CG" Series Ventilators specify spring color in accordance with up to 6' red, up to 12' silver****2019 PRICE**

up 16' yellow DS hood length.

**Blower Switch required on all GXB, 100, and 200 controls**

| Gaylord Part # | Description   |            |
|----------------|---|------------|
| 12671          | C-61-L DAMPER CONTROL SWITCH – CG-BDL ELECTRIC DAMPER **                        | \$1,708.36 |
| 12680          | C-61-GXS DAMPER CONTROL SWITCH – GX-AB & GX-CE ELECTRIC DAMPER                  | \$1,030.45 |
| 12703          | C-61 CG DAMPER CONTROL WITH SWITCH (120 VOLT)                                   | \$1,195.85 |
| 12679          | C-61-GXB-RG DAMPER CONTROL SWITCH – RG FUSE LINK DAMPER                         | \$471.93   |
| 13036          | C-61-GXSH DAMPER CONTROL SWITCH – GX-BDL ELECTRIC DAMPER (LEFT OR RIGHT) *      | \$1,347.64 |
| 13220          | C-61-GXB DAMPER CONTROL SWITCH – GX FUSE LINK DAMPER (LEFT OR RIGHT) *          | \$659.56   |
| 17090          | C-61-GXSH-RG DAMPER CONTROL SWITCH – RG-BDL ELECTRIC DAMPER                     | \$1,347.25 |
| 17091          | C-61-GXS-RG DAMPER CONTROL SWITCH – RG-AB ELECTRIC DAMPER                       | \$981.39   |
| 18317          | C-99-CG3DAMPER CONTROL SWITCH – CG3 ELECTRIC DAMPER (24 VOLT includes sprocket) | \$2,482.42 |
| 20331          | C-61-SH DAMPER CONTROL SWITCH*  | \$1,247.82 |

\* SPECIFY EXTENSION LINKAGE LENGTH - 2", 6" OR 12" AND HANDLE LENGTH - 15", 18" OR 24"

\*\* SPECIFY HANDLE LENGTH - 15", 18" OR 24"

**COMPONENT PARTS FOR COMMERCIAL DAMPER CONTROL SWITCHES**

| Gaylord Part # | Description   |            |
|----------------|---|------------|
| 10006          | 115 VOLT SOLENOID COIL FOR C-61   | \$123.31   |
| 11328          | 220 VOLT SOLENOID COIL FOR C-61   | \$86.95    |
| 18979          | 24V DAMPER ACTUATOR FOR CG3 WITH C-6000 CONTROLS  | \$1,844.40 |
| 18449          | C-99 GX2 DAMPER ACTUATOR 230V   | \$1,921.09 |
| 22471          | DAMPER ACTUATOR 120V FOR A GX2 (120V)   | \$1,778.90 |
| 19238          | DAMPER ACTUATOR FOR CG3 WITH C-5000-99*MUST ORDER WITH PART NUMBER 22043-DAMPER SPROCKET* | \$1,750.45 |
| 22043          | C-5000-99 DAMPER SPROCKET   | \$11.89    |
| 10012          | 7 X 9 LID FOR DAMPER CONTROL BOX  | \$148.62   |
| 10023          | LEFT SIDE LID GASKET 7" X 9" WITH PSA (PACKS OF 5)  | \$29.02    |
| 18211          | RIGHT SIDE LID GASKET 7" X 9" WITH PSA (PACKS OF 5)                                       | \$29.02    |
| 10847          | LEFT SIDE LID GASKET 7" X 13" WITH PSA (PACKS OF 5)                                       | \$49.97    |
| 10848          | RIGHT SIDE LID GASKET 7" X 13" WITH PSA (PACKS OF 5)                                      | \$49.97    |
| 10022          | LID SCREWS #8 PHILLIPS HEAD (PACK OF 100)   | \$42.03    |
| 10011          | L-HANDLE w/HARWARE INCLUDING RED BALL ***SPECIFY HANDLE LENGTH***                         | \$178.94   |
| 10021          | SH-HANDLE w/HARWARE INCLUDING RED BALL ***SPECIFY LINKAGE & HANDLE LENGTH***              | \$207.71   |
| 10008          | DAMPER ACTUATING ARM (DAMPER CONTROL TO DAMPER)   | \$53.36    |

\*SPECIFY HANDLE LENGTH - 15", 18", 24" OR 35"

**NAVY DAMPER CONTROL SWITCHES**

**IMPORTANT NOTE: Damper Control Switches for "CG" Series Ventilators specify spring color in accordance with up to 6' red, up to 12' silver, up 16' yellow DS hood length.**

PAGE 3

| Gaylord Part # | Description   |            |
|----------------|---|------------|
| 12687          | N-66 DAMPER CONTROL SWITCH 115V – NA, NAB, NC-TOP MT          | \$904.40   |
| 12688          | N-66-L DAMPER CONTROL SWITCH 115V – NBDL **                   | \$1,013.60 |
| 12689          | N-66-R DAMPER CONTROL SWITCH 115V – NAD-SIDE MT               | \$1,253.58 |
| 12690          | N-66-E DAMPER CONTROL SWITCH 115V – NE-UNDER SHELF            | \$1,192.37 |
| 16653          | N-66-LDS DAMPER CONTROL SWITCH 115V – NBDL-DS **              | \$937.80   |
| 12692          | N-66-RE-S DAMPER CONTROL SWITCH 115V – NE-SIDE MT             | \$1,094.05 |
| 13037          | N-66-RE-T DAMPER CONTROL SWITCH 115V – NE-TOP MT              | \$1,371.83 |
| 12693          | N-66-SH DAMPER CONTROL SWITCH 115V – NBD *                    | \$1,197.29 |
| 18684          | N-66/220 DAMPER CONTROL SWITCH 220V – NA, NAB, NC-TOP MT      | \$1,142.88 |
| 18685          | N-66-L/220 DAMPER CONTROL SWITCH 220V – NBDL **               | \$1,249.04 |
| 18686          | N-66-R/220 DAMPER CONTROL SWITCH 220V – NAD-SIDE MT           | \$1,408.04 |
| 18687          | N-66-E/220 DAMPER CONTROL SWITCH 220V – NE-UNDER SHELF        | \$1,437.69 |
| 18688          | N-66LDS/220 DAMPER CONTROL SWITCH 220V – NBDL-DS **           | \$1,170.86 |
| 18689          | N-66-RE-S/220 DAMPER CONTROL SWITCH 220V – NE-SIDE MT         | \$1,337.34 |
| 18690          | N-66-RE-T/220 DAMPER CONTROL SWITCH 220V – NE-TOP MT          | \$1,315.24 |
| 18691          | N-66-SH/220 DAMPER CONTROL SWITCH 220V – NBD *                | \$1,236.37 |
| 12696          | N-66/220 DAMPER CONTROL SWITCH 220V – NA, NB, NAB, NC-TOP MT  | \$899.56   |
| 16802          | N-66-RL/220 DAMPER CONTROL SWITCH 220V – NAD-SIDE MT/L HAND   | \$1,213.86 |
| 16801          | N-66-RE-S/220 DAMPER CONTROL SWITCH 220V – NE-SIDE MT         | \$1,299.61 |
| 16800          | N-66-SH/220 DAMPER CONTROL SWITCH 220V – NBD *                | \$1,207.46 |
| 16799          | N-66-G/220 DAMPER CONTROL SWITCH 220V – AUX EXH TERM          | \$1,033.61 |
| 12695          | N-68/440V DAMPER CONTROL SWITCH 440V – NA, NB, NAB, NC-TOP MT | \$2,080.91 |
| 12698          | N-68-E DAMPER CONTROL SWITCH 440V – NE-UNDER SHELF            | \$1,247.66 |

**NAVY DAMPER CONTROL SWITCHES**

|       |   |            |
|-------|---|------------|
| 12699 | N-68-L/440V DAMPER CONTROL SWITCH 440V – NBDL **                | \$1,349.74 |
| 12700 | N-68-LDS DAMPER CONTROL SWITCH 440V – NBDL-DS **                | \$1,276.59 |
| 12701 | N-68-R/440V DAMPER CONTROL SWITCH 440V – NAD-SIDE MT            | \$1,544.13 |
| 12691 | N-68-RL/440V DAMPER CONTROL SWITCH 440V – NAD-SIDE MT/L HAND ** | \$1,499.38 |
| 12708 | N-68-RE-S DAMPER CONTROL SWITCH 440V – NE-SIDE MT               | \$2,543.71 |
| 13198 | N-68-RE-T/440V DAMPER CONTROL SWITCH 440V – NE-TOP MT           | \$1,376.65 |
| 12702 | N-68-SH/440V DAMPER CONTROL SWITCH 440V – NBD *                 | \$2,696.71 |
| 12705 | N-68-G/440V DAMPER CONTROL SWITCH 440V – AUX EXH TERM           | \$2,207.02 |
| 12706 | N-68-NM/440V DAMPER CONTROL SWITCH 440V – NON-MAG               | \$1,185.10 |
| 12697 | N-68-B DAMPER CONTROL SWITCH WITH BLOWER SWITCH                 | \$1,280.09 |
| 16976 | DAMPER CONTROL SWITCH N-97                                      | \$2,863.39 |

**\*SPECIFY EXTENSION LINKAGE LENGTH - 2", 6" OR 12" AND/OR \*\*HANDLE LENGTH - 15", 18" OR 24"**

**COMPONENT PARTS FOR NAVY DAMPER CONTROL SWITCHES**

| Gaylord Part # | Description  |          |
|----------------|--|----------|
| 10023          | LEFT SIDE LID GASKET 7" X 9" WITH PSA (PACKS OF 5)   | \$29.02  |
| 18211          | RIGHT SIDE LID GASKET 7" X 9" WITH PSA (PACKS OF 5)  | \$29.02  |
| 10847          | LEFT SIDE LID GASKET 7" X 13" WITH PSA (PACKS OF 5)  | \$49.97  |
| 10848          | RIGHT SIDE LID GASKET 7" X 13" WITH PSA (PACKS OF 5) | \$49.97  |
| 10008          | DAMPER ACTUATING ARM (DAMPER CONTROL TO DAMPER)      | \$53.36  |
| 12712          | SOLENOID REPAIR KIT 115V - N66/N68 SRK               | \$304.36 |
| 15628          | SOLENOID REPAIR KIT 220V - N66 SRK                   | \$387.74 |
| 15625          | SOLENOID REPAIR KIT 220V - N68 SRK                   | \$414.00 |
| 12713          | SOLENOID REPAIR KIT 440V - N68 SRK                   | \$537.46 |

**NAVY BREAK GLASS STATION**

| <b>Gaylord Part #</b> | <b>Description</b>           |                           | <b>PAGE 4</b> |
|-----------------------|------------------------------|---------------------------|---------------|
| 17001                 | BREAK GLASS STATION 115 VOLT | ***NO DISCOUNT ALLOWED*** | \$1,831.43    |
| 12826                 | BREAK GLASS STATION 440 VOLT | ***NO DISCOUNT ALLOWED*** | \$1,831.43    |

**NAVY BREAK GLASS STATION REPAIR KITS**

| <b>Gaylord Part #</b>                                  | <b>Description</b>   |  |            |
|--|--|--|------------|
| 17028  | REPAIR KIT FOR BREAK GLASS STATION 115 VOLT                |  | \$1,247.24 |
| 12827  | REPAIR KIT FOR BREAK GLASS STATION 440 VOLT                |  | \$1,247.24 |
| 11039  | 440V RELAY FOR BREAK GLASS STATION                         |  | \$640.48   |
| 17050  | SPARE GLASS AND BUTTON TACK FOR NDS-61-BG                  |  | \$274.45   |
| 15120  | BREAK GLASS KIT INCLUDES SWITCH, HAMMER, REPLACEMENT GLASS |  | \$799.28   |
| <b>INCLUDES: (6) GLASS DISKS &amp; (1) BUTTON TACK</b> |  |  |            |

**DOOR HANDLES FOR CONTROL CABINETS**

| <b>Gaylord Part #</b> | <b>Description</b>                             |  |          |
|-----------------------|--|--|----------|
| 75584                 | CHROME "T" DOOR HANDLE WITH TONGUE KIT         |  | \$32.96  |
| 75585                 | CHROME LOCKING "T" DOOR HANDLE WITH TONGUE KIT |  | \$34.32  |
| 14953                 | FLUSH LATCH DOOR HANDLE WITH TONGUE KIT        |  | \$112.28 |
| 75587                 | 4" PULL HANDLE KIT FOR GX INSERTS (PACK OF 2)  |  | \$35.80  |
| 20937                 | NAD HANDLE KIT                                 |  | \$62.80  |

**GAYLORD WATER SOLENOID VALVES FOR PRODUCT MANUFACTURED AFTER 2006 (GPC-6000C & D, GPC-7000, GRC-5000)**

**SOLENOID COIL IS NOT INCLUDED.**

PAGE 5

| <b>Gaylord Part #</b> | <b>Description</b>    |  |
|-----------------------|-----------------------|--|
| 12027                 | 1/2" SOLENOID VALVE   | \$217.02   |
| 12028                 | 3/4" SOLENOID VALVE   | \$253.26   |
| 12029                 | 1" SOLENOID VALVE     | \$975.66   |
| 12030                 | 1 1/4" SOLENOID VALVE | \$1,194.64   |
| 12031                 | 1 1/2" SOLENOID VALVE | ****COMBINE AND CREATE BILL NUMBER****<br>\$1,812.29 |

**GAYLORD WATER SOLENOID COILS FOR PRODUCT MANUFACTURED AFTER 2006 (GPC-6000C & D, GPC-7000, GRC-5000)**

| <b>Gaylord Part #</b> | <b>Description</b>                  |          |
|-----------------------|-------------------------------------|----------|
| 12032                 | 24 VOLT SOLENOID COIL 1/2" TO 3/4"  | \$104.26 |
| 12033                 | 120 VOLT SOLENOID COIL 1/2" TO 3/4" | \$106.44 |
| 12034                 | 240 VOLT SOLENOID COIL 1/2" TO 3/4" | \$104.26 |
| 12035                 | 24 VOLT SOLENOID COIL 1" TO 1 1/2"  | \$71.56  |
| 12036                 | 120 VOLT SOLENOID COIL 1" TO 1 1/2" | \$73.42  |
| 12037                 | 240 VOLT SOLENOID COIL 1" TO 1 1/2" | \$73.52  |

**GAYLORD WATER SOLENOID VALVE REPAIR KITS FOR PRODUCT MANUFACTURED AFTER 2006 (GPC-6000C & D, GPC-7000, GRC-5000)**

| <b>Gaylord Part #</b> | <b>Description</b>      |            |
|-----------------------|-------------------------|------------|
| 12038                 | 1/2" VALVE REPAIR KIT   | \$128.08   |
| 12039                 | 3/4" VALVE REPAIR KIT   | \$128.08   |
| 12041                 | 1" VALVE REPAIR KIT     | \$707.57   |
| 12042                 | 1 1/2" VALVE REPAIR KIT | \$1,862.70 |

**GAYLORD WATER SOLENOID VALVES - SLOW CLOSE - FOR GPC-4000, GPC-5000, C-6000, & GRC-5000 CONTROL CABINETS FOR EQUIPMENT MANUFACTURED BEFORE 2006**

| Gaylord Part # | Description                            |            |
|----------------|--|------------|
| 10142          | ¾" GAYLORD SOLENOID VALVE SLOW CLOSE   | \$438.45   |
| 10143          | 1" GAYLORD SOLENOID VALVE SLOW CLOSE   | \$1,191.15 |
| 10144          | 1 ¼" GAYLORD SOLENOID VALVE SLOW CLOSE | \$1,422.21 |
| 10140          | 1 ½" GAYLORD SOLENOID VALVE SLOW CLOSE | \$2,451.52 |
| 15304          | 2' GAYLORD SOLENOID VALVE SLOW CLOSE   | \$2,451.52 |

**SLOW CLOSE SOLENOID VALVE REPAIR KITS FOR EQUIPMENT MANUFACTURED BEFORE 2006**

| Gaylord Part # | Description                            |          |
|----------------|--|----------|
| 14387          | ½" GAYLORD SOLENOID VALVE REPAIR KIT   | \$397.31 |
| 14388          | ¾" GAYLORD SOLENOID VALVE REPAIR KIT   | \$437.04 |
| 14389          | 1" GAYLORD SOLENOID VALVE REPAIR KIT   | \$799.02 |
| 14390          | 1 ¼" GAYLORD SOLENOID VALVE REPAIR KIT | \$997.68 |
| 14391          | 1 ½" GAYLORD SOLENOID VALVE REPAIR KIT | \$830.63 |

**WATER SOLENOID VALVES - STANDARD CLOSE - FOR GPC-100, 200, 3000 SERIES CONTROL CABINETS **MANUFACTURED****

| Gaylord Part # | Description                             |            |
|----------------|---|------------|
| 10135          | ½" GAYLORD SOLENOID VALVE NORM CLOSED   | \$351.87   |
| 10132          | 1" GAYLORD SOLENOID VALVE NORM CLOSED   | \$608.55   |
| 10138          | 1 ¼" GAYLORD SOLENOID VALVE NORM CLOSED | \$738.34   |
| 10131          | 1 ½" GAYLORD SOLENOID VALVE NORM CLOSED | \$1,130.58 |

**STANDARD CLOSE SOLENOID VALVE REPAIR KITS FOR EQUIPMENT MANUFACTURED BEFORE 2006**

| Gaylord Part # | Description  |          |
|----------------|--|----------|
| 10122          | ½" GAYLORD STANDARD CLOSE WATER SOLENOID VALVE REPAIR KIT        | \$264.87 |
| 10123          | ¾" GAYLORD STANDARD CLOSE WATER SOLENOID VALVE REPAIR KIT        | \$264.87 |
| 10124          | 1" - 1 ¼" GAYLORD STANDARD CLOSE WATER SOLENOID VALVE REPAIR KIT | \$388.44 |
| 10125          | 1 ½" GAYLORD STANDARD CLOSE WATER SOLENOID VALVE REPAIR KIT      | \$490.01 |

**COILS FOR WATER SOLENOID VALVES FOR EQUIPMENT MANUFACTURED BEFORE 2006**

| Gaylord Part # | Description   |          |
|----------------|---|----------|
| 10156          | 120V REPLACE COIL FOR GAYLORD WATER SOLENOID (G SERIES) | \$256.04 |
| 10157          | 240V REPLACE COIL FOR GAYLORD WATER SOLENOID (G SERIES) | \$256.04 |

**WATER SOLENOID VALVE - NORMALLY OPEN - FOR FREEZE PROTECTION DRAIN OFF**

| Gaylord Part # | Description                             |            |
|----------------|---|------------|
| 10128          | 1/2" GAYLORD SOLENOID VALVE NORM OPEN   | \$579.50   |
| 10127          | 1" GAYLORD SOLENOID VALVE NORM OPEN     | \$1,706.45 |
| 16284          | 1 1/4" GAYLORD SOLENOID VALVE NORM OPEN | \$1,733.15 |
| 16285          | 1 1/2" GAYLORD SOLENOID VALVE NORM OPEN | \$2,160.43 |

**BALL VALVES**

PAGE 7

| Gaylord Part # | Description                      |          |
|----------------|----------------------------------|----------|
| 11258          | ½" FMT THD BALL VALVES, BRONZE   | \$18.87  |
| 11263          | ¾" FMT THD BALL VALVES, BRONZE   | \$28.31  |
| 11255          | 1" FMT THD BALL VALVES, BRONZE   | \$48.71  |
| 10167          | 1 ¼" FMT THD BALL VALVES, BRONZE | \$102.47 |
| 11256          | 1 ½" FMT THD BALL VALVES, BRONZE | \$146.85 |
| 11260          | 2" FMT THD BALL VALVES, BRONZE   | \$211.93 |

**VACUUM BREAKERS**

| Gaylord Part # | Description       |            |
|----------------|-------------------|------------|
| 10177          | ½" V.B. (ANGLE)   | \$406.12   |
| 10179          | ¾" V.B. (ANGLE)   | \$483.30   |
| 10180          | 1" V.B. (ANGLE)   | \$635.93   |
| 10181          | 1 ¼" V.B. (ANGLE) | \$1,217.96 |
| 10182          | 1 ½" V.B. (ANGLE) | \$1,286.67 |
| 10183          | 2" V.B. (ANGLE)   | \$1,222.86 |

**VACUUM BREAKER REPAIR KITS**

| Gaylord Part # | Description          |          |
|----------------|----------------------|----------|
| 10178          | ½" V.B. REPAIR KIT   | \$117.87 |
| 10184          | ¾" V.B. REPAIR KIT   | \$117.21 |
| 10185          | 1" V.B. REPAIR KIT   | \$117.21 |
| 10186          | 1 ¼" V.B. REPAIR KIT | \$159.62 |
| 10187          | 1 ½" V.B. REPAIR KIT | \$399.33 |

**WATER CHECK VALVES**

| Gaylord Part # | Description            |          |
|----------------|------------------------|----------|
| 10195          | ½" WATER CHECK VALVE   | \$69.79  |
| 10196          | ¾" WATER CHECK VALVE   | \$90.99  |
| 10197          | 1" WATER CHECK VALVE   | \$118.35 |
| 10198          | 1 ¼" WATER CHECK VALVE | \$167.33 |
| 10199          | 1 ½" WATER CHECK VALVE | \$284.77 |

**BACKFLOW PREVENTERS**

| Gaylord Part # | Description             |            |
|----------------|-------------------------|------------|
| 11317          | ¾" BACKFLOW PREVENTER   | \$1,244.13 |
| 11320          | 1" BACKFLOW PREVENTER   | \$1,474.23 |
| 11319          | 1 ¼" BACKFLOW PREVENTER | \$2,612.57 |
| 11318          | 1 ½" BACKFLOW PREVENTER | \$2,461.00 |

**BRASS LINE STRAINERS-FOR ALL WASH HOODS**

| Gaylord Part # | Description        |          |
|----------------|--------------------|----------|
| 18114          | ½" LINE STRAINER   | \$181.97 |
| 17138          | ¾" LINE STRAINER   | \$173.36 |
| 17139          | 1" LINE STRAINER   | \$238.47 |
| 17140          | 1 ¼" LINE STRAINER | \$377.83 |
| 18115          | 1 ½" LINE STRAINER | \$510.72 |

**DETERGENT PUMPS FOR ALL MODELS OF CONTROL CABINETS**

| Gaylord Part # | Description                  | PAGE 8     |
|----------------|------------------------------|------------|
| 10222          | 120V DETERGENT PUMP          | \$1,067.23 |
| 10223          | 220V DETERGENT PUMP          | \$984.08   |
| 10224          | 115V CANADIAN DETERGENT PUMP | \$1,069.24 |

**DETERGENT PUMP PARTS - \*ITEM NOT STOCKED, ALLOW TWO WEEKS FOR DELIVERY**

| Gaylord Part # | Description                            |          |
|----------------|--|----------|
| 10231          | ARMATURE BEARING                       | \$69.16  |
| 10232          | MOTOR COIL 115V                        | \$182.96 |
| 10259          | MOTOR COIL 220V                        | \$305.35 |
| 10233          | ARMATURE                               | \$103.16 |
| 10234          | ARMATURE SPACER (PACK OF 5)            | \$26.04  |
| 10235          | BRACKET                                | \$103.16 |
| 10236          | SET SCREW (PACK OF 10)                 | \$27.03  |
| 10237          | YOKE AND BEARING ASSEMBLY              | \$70.61  |
| 10238          | PUSH BUTTON TEST SWITCH                | \$114.16 |
| 10239          | BRACKET SCREW 10-32 X 3/8 (PACK OF 50) | \$19.07  |
| 10240          | DIAPHRAGM                              | \$70.90  |
| 10242          | BRASS OUTLET                           | \$28.79  |

**DETERGENT PUMP PARTS - \*ITEM NOT STOCKED, ALLOW TWO WEEKS FOR DELIVERY**

|       |                                      |          |
|-------|--------------------------------------|----------|
| 10244 | TOP CAP                              | \$18.88  |
| 10246 | POPPET CHECK SPRING (PACK OF 5)      | \$18.19  |
| 10247 | PUMP HEAD COMPLETE WITHOUT DIAPHRAGM | \$212.33 |
| 10248 | MOUNTING SCREW (PACK OF 5)           | \$18.19  |
| 10250 | POPPET CHECK (PACK OF 5)             | \$18.81  |
| 10251 | O-RING (PACK OF 10)                  | \$23.15  |
| 10253 | GEAR BOX ASSEMBLY 60RPM              | \$335.17 |
| 20466 | ADJUSTABLE CAM 1-6                   | \$56.19  |
| 10254 | CAM #1 FOR 1/2" PIPE                 | \$19.42  |
| 10255 | CAM #2 FOR 3/4" PIPE                 | \$18.19  |
| 10256 | CAM #3 FOR 1" PIPE                   | \$18.19  |
| 10257 | CAM #4 FOR 1 1/4" & 1 1/2" PIPE      | \$18.19  |

**DETERGENT PUMP PARTS - \*ITEM NOT STOCKED, ALLOW TWO WEEKS FOR DELIVERY**

|       |  |          |
|-------|--|----------|
| 10260 | INLET ADAPTER WITH O RING                                | \$18.19  |
| 10261 | TUBE NUT FOR 1/4" VINYL TUBING (PACK OF 5)               | \$22.07  |
| 10262 | BRASS DETERGENT CHECK VALVE 1/4FLR X 1/4FL               | \$119.08 |
| 10263 | BRASS DETERGENT CHECK VALVE 3/8 X 3/8TB (PLASTIC TUBING) | \$119.08 |
| 10264 | BRASS DETERGENT CHECK VALVE 1/4 FLR X 1/4 MPT            | \$119.08 |
| 10265 | BRASS DETERGENT CHECK VALVE 1/4 FLR X 3/8 FLR            | \$119.08 |

**DETERGENT PUMP PARTS - \*ITEM NOT STOCKED, ALLOW TWO WEEKS FOR DELIVERY**

|       |  |          |
|-------|--|----------|
| 10266 | INLET CHECK VALVE SPRING (PACK OF 5)   | \$22.38  |
| 10268 | TUBE NUT 1/4                           | \$18.19  |
| 10269 | FOOT VALVE                             | \$56.00  |
| 10271 | ALLEN WRENCH 1/16                      | \$19.42  |
| 10272 | VINYL TUBING 1/2" (PER FOOT)           | \$2.55   |
| 10273 | COPPER TUBING 1/4" (PER FOOT)          | \$4.85   |
| 10275 | PUMP HEAD AND FOOT VALVE KIT           | \$353.33 |
| 15124 | WEIGHT FOR DETERGENT PUMP VINYL TUBING | \$19.42  |



**PLUMBING CABINET PARTS**

PAGE 9

| <b>Gaylord Part #</b> | <b>Description</b>   |          |
|-----------------------|--|----------|
| 10221                 | STAINLESS STEEL DETERGENT TANK (REPLACES PLASTIC DETERGENT TANK) | \$395.98 |
| 10175                 | PRESSURE TEMPERATURE GAUGE, 0-200 PSI, 70-320                    | \$298.42 |
| 10158                 | SHOCK ABSORBER FOR GPC-200 AND 3000 SERIES                       | \$75.24  |

**PLUMBING PARTS FOR COLD WATER MIST**

| <b>Gaylord Part #</b> | <b>Description</b>               |          |
|-----------------------|----------------------------------|----------|
| 10135                 | ½" SOLENOID VALVE NORM CLOSED    | \$351.87 |
| 10924                 | ½" WATER PRESSURE REDUCING VALVE | \$297.08 |
| 10276                 | PRESSURE GAUGE (RANGE 0-100 PSI) | \$75.55  |
| 10151                 | ½" LINE STRAINER                 | \$43.03  |
| 11258                 | ½" FMT THD BALL VALVE, BRONZE    | \$18.87  |
| 10195                 | ½" CHECK VALVE                   | \$72.23  |
| 10177                 | ½" V.B.                          | \$406.12 |

**PLUMBING CONTROL CABINETS****CONSULT FACTORY FOR PRICING ON ALL CONTROL CABINETS****AVAILABLE IN 120V AND 220V****ALLOW SIX WEEKS FOR FABRICATION**

**MODEL C-7000 SERIES COMPLETE CONTROLS**

PAGE 10

**FURNISHED COMPLETE MOUNTED ON CHASSIS - ALLOW 2 WEEKS FOR FABRICATION****NOTE: CONTROLS ARE STANDARD 120V; 220V IS OPTIONAL****MODEL C-7000A SERIES COMPLETE CONTROLS**

| Gaylord Part # | Description                                 |            |
|----------------|---|------------|
| 20790          | C-7000A S1-S4                               | \$6,869.16 |
| 20791          | C-7000A S5-S10                              | \$7,227.27 |
| 20958          | C-7000A S11-S16 FOR USE WITH RSPC-ESP UNITS | \$8,222.46 |
| 20791          | C-7000A-UVI-S0-S10 Control                  | \$7,227.27 |
| 22301          | C-7000A ESP MODULE ASSEMBLY                 | \$2,310.46 |
| 22517          | C-7000 Circuit Board Only                   | \$1,664.02 |

**MODEL C-6000 SERIES COMPLETE CONTROLS****FURNISHED COMPLETE MOUNTED ON CHASSIS - ALLOW 6-8 WEEKS FOR FABRICATION****NOTE: CONTROLS ARE STANDARD 120V; 220V OPTION MUST BE PURCHASED SEPERATELY**

| Gaylord Part # | Description   |            |
|----------------|---|------------|
| 30890          | C-6000-D STANDARD CONTROL                               | \$7,075.24 |
| 30889          | C-6000-D SEQUENTIAL CONTROL UP TO 9 SEQUENCES           | \$7,704.63 |
| 30888          | C-6000-D SEQUENTIAL CONTROL UP TO 13 SEQUENCES          | \$8,428.06 |
| 30856          | C-6000-D SEQUENTIAL CONTROL FOR UV VENTILATORS          | \$7,704.62 |
| 30884          | C-6000-C STANDARD CONTROL                               | \$6,691.81 |
| 30885          | C-6000-C SEQUENCE CONTROL                               | \$7,596.11 |
| 20929          | C-6000-B to C-6000-D CONVERSION KIT, STANDARD CONTROL   | \$2,891.37 |
| 20936          | C-6000-B to C-6000-D CONVERSION KIT, SEQUENTIAL CONTROL | \$2,891.37 |
| 30876          | 220V OPTION FOR CONTROLS                                | \$1,786.89 |

**C-6000 ESP CONTROL PARTS****FURNISHED COMPLETE MOUNTED ON CHASSIS - ALLOW 6 WEEKS FOR FABRICATION****NOTE: CONTROLS ARE STANDARD 120V; 220V IS OPTIONAL**

| Gaylord Part # | Description                                    |            |
|----------------|--|------------|
| 30890          | C-6000-ESP-S1                                  | \$7,075.24 |
| 30889          | C-6000-D SEQUENTIAL CONTROL UP TO 9 SEQUENCES  | \$7,704.63 |
| 30888          | C-6000-D SEQUENTIAL CONTROL UP TO 13 SEQUENCES | \$8,428.06 |
| 19157          | C-6000-ESP RETRO FIT FACE PLATE                | \$78.57    |
| 30876          | 220V OPTION FOR CONTROLS                       | \$1,786.89 |

**GRC-5000 CONTROL****FURNISHED COMPLETE MOUNTED ON CHASSIS - ALLOW 6 WEEKS FOR FABRICATION****NOTE: CONTROLS ARE STANDARD 120V, 220V OPTION MUST BE PURCHASED SEPERATELY**

| Gaylord Part # | Description  |            |
|----------------|--|------------|
| 30877          | GRC-5000 STANDARD CONTROL  | \$6,828.67 |
| 30878          | GRC-5000 SEQUENTIAL CONTROL  | \$7,756.02 |
| 19988          | GRC-5000 J-BOX ***MEASUREMENTS: 11 1/2"L x 5"W x 3 1/2"D***              | \$99.25    |
| 19984          | GRC-5000 RETRO-FIT PLATE ***FOR USE WHEN REPLACING C-100 CONTROL ONLY*** | \$64.75    |
| 23249          | GRC-5000 RETRO-FIT CONTROL FOR C-5000-99 SYSTEMS                         | \$7,995.73 |

**TSC/TST AUTO START SYSTEM**

|       |   |            |
|-------|---|------------|
| 76017 | TEMPERATURE SENSING CONTROL                                   | \$1,031.23 |
| 76004 | TEMPERATURE SENSING THERMOSTAT ASSEMBLY PRE-SET AT 90 DEGREE  | \$506.88   |
| 20550 | TEMPERATURE SENSING THERMOSTAT ASSEMBLY PRE-SET AT 280 DEGREE | \$506.88   |

**DCA AUTO START SYSTEM**

|       |                             |            |
|-------|-----------------------------|------------|
| 22271 | DCAP PRIMARY CONTROL BOX    | \$1,603.21 |
| 22272 | DCAS SECONDARY CONTROL BOX  | \$703.51   |
| 20319 | DCA RTD ASSEMBLY W/1' CABLE | \$177.68   |

**OPERATOR INTERFACE****Gaylord Part # Description**

|       |   |            |
|-------|---|------------|
| 30879 | OPERATOR INTERFACE FOR GRC-5000   | \$1,501.87 |
| 30881 | OPERATOR INTERFACE FOR C-6000-C   | \$1,501.87 |
| 20115 | OPERATOR INTERFACE FOR C-6000-D   | \$1,501.87 |
| 20527 | OPERATOR INTERFACE FOR C-7000   | \$1,501.87 |
| 30880 | PLC TO OPERATOR INTERFACE CABLE FOR GRC-5000, C6000-ESP, C6000-C, C6000-D | \$168.89   |

**PROGRAMMABLE LOGIC CONTROLLER (PLC)****Gaylord Part # Description**

|       |   |            |
|-------|---|------------|
| 20923 | PLC FOR GRC-5000 ***NOTE IF STANDARD OR SEQUENTIAL CONTROL*** | \$2,145.53 |
| 20114 | PLC FOR C-6000-D S1 (INCLUDES PROGRAM)                        | \$1,953.29 |
| 20114 | PLC FOR C-6000-D S2+ (INCLUDES PROGRAM)                       | \$1,953.29 |
| 30882 | PLC FOR C-6000-C-S1 (INCLUDES PROGRAM)                        | \$1,953.29 |
| 30883 | PLC FOR C-6000-C-S2+ (INCLUDES PROGRAM)                       | \$1,953.29 |
| 20526 | PLC FOR C-7000 (INCLUDES PROGRAM)                             | \$1,953.29 |
| 18867 | EXPANSION MODULE (OPTIONAL - USED FOR S2-S5)                  | \$903.97   |
| 22453 | PLC Battery   | \$72.10    |

**C-6000 SERIES CONTROL PARTS****Gaylord Part # Description**

|       |  |          |
|-------|--|----------|
| 18863 | 24VDC POWER SUPPLY                                       | \$196.86 |
| 13062 | FUSE (F1) - 2 AMP 24VDC POWER SUPPLY (pack of 5)         | \$15.25  |
| 10039 | FUSE (F2) - 4 AMP PLC 120 VAC (pack of 5)                | \$15.25  |
| 19027 | FUSE (F3) - 1AMP SUPPLY FAN MAG. STARTER (pack of 5)     | \$28.11  |
| 19027 | FUSE (F4) - 1 AMP EXHAUST FAN MAG STARTER (pack of 5)    | \$28.11  |
| 13062 | FUSE (F5) - 2 AMP (C-6000-10) TRANS. PRIMARY (pack of 5) | \$15.25  |
| 10039 | FUSE (F5) - 4 AMP (C-6000-20) TRANS. PRIMARY (pack of 5) | \$15.25  |
| 19020 | FUSE (F6) - 6 AMP TRANSFORMER SECONDARY                  | \$19.71  |
| 10039 | FUSE (F7) - 4 AMP (UV CONTROLS) (pack of 5)              | \$15.25  |
| 18980 | FLASH GUARD (SPECIFY CONTROL)                            | \$71.91  |
| 18981 | 100 VA TRANSFORMER                                       | \$274.84 |
| 18891 | 250 VA TRANSFORMER                                       | \$611.30 |
| 10035 | START SWITCH (TO USE WITH A C-5000B AND MARINE CONTROL)  | \$21.33  |
| 18983 | C-6000 OUTPUT MODULE                                     | \$758.53 |
| 19319 | SONALERT (UV CONTROL)                                    | \$154.42 |
| 30375 | TIMING RELAY (TR1, TR2 UV CONTROL)                       | \$317.81 |
| 19272 | SOCKET 8-PIN FOR TIMING RELAY (UV CONTROL)               | \$22.80  |
| 16892 | LOW DETERGENT FLOW SWITCH                                | \$629.39 |
| 16893 | 1/8 PORT ADAPTER FOR FLOW SWITCH                         | \$27.12  |

**MODEL C-200 & NC-200 SERIES CONTROL ELECTRICAL PARTS**

| <b>Gaylord Part #</b> | <b>Description</b>   |          |
|-----------------------|--|----------|
| 10280                 | AGASTAT SOCKET BASE  | \$83.87  |
| 10049                 | AGASTAT SOLID STATE TIMER 115V - ADD JUMPER TERMINAL 6 TO TERMINAL 7 | \$560.82 |
| 10050                 | AGASTAT SOLID STATE TIMER 220V                                       | \$731.24 |
| 13039                 | FUSE HOLDER  | \$17.19  |
| 10039                 | 4 AMP 250V SMALL DIM FUSE (PACK OF 5)                                | \$15.25  |
| 10283                 | CONTROL RELAY R3   | \$50.15  |
| 10295                 | DPDT RELAY SOCKET BASE   | \$31.76  |
| 10051                 | OPERATOR BASE W/SHROUD   | \$70.51  |
| 10052                 | AMBER "BY-PASS" LENS WITH "BY-PASS" INSCRIPTION DISK                 | \$23.53  |
| 10053                 | GREEN "START" LENS WITH "START" INSCRIPTION DISK                     | \$30.30  |
| 10054                 | RED "STOP" LENS WITH "STOP" INSCRIPTION DISK                         | \$23.53  |
| 10055                 | RED "RESET" LENS   | \$23.53  |
| 10058                 | BLANK INSCRIPTION LENS ONLY (PACK OF 5)                              | \$27.28  |
| 10057                 | 6V BULB  | \$20.46  |
| 10056                 | 115V BY-PASS SWITCH ASSEMBLY   | \$259.33 |
| 75628                 | 440V NAVY BY-PASS SWITCH ASSEMBLY                                    | \$294.72 |
| 12770                 | 115V COMMERCIAL STOP SWITCH ASSEMBLY                                 | \$286.20 |
| 12771                 | 115V COMMERCIAL START SWITCH ASSEMBLY                                | \$265.11 |
| 75627                 | 440V NAVY STOP SWITCH ASSEMBLY                                       | \$294.72 |
| 75626                 | 440V NAVY START SWITCH ASSEMBLY                                      | \$294.72 |
| 10059                 | N/C CONTACT BLOCK (STOP)   | \$23.80  |
| 10060                 | N/O CON BLK/STOP, START, BY-PASS                                     | \$26.39  |
| 10062                 | LAMP HOLDER (SHORT)  | \$14.54  |
| 10064                 | TRANSFORMER 120V/6V  | \$89.34  |
| 10066                 | TRANSFORMER 440V/6V  | \$96.15  |
| 10093                 | TRANS 440/115V (NAVY CONTROL)  | \$197.00 |

**MODEL C-100 SERIES CONTROL ELECTRICAL PARTS**

| <b>Gaylord Part #</b> | <b>Description</b>                    |            |
|-----------------------|---------------------------------------|------------|
| 10033                 | AGASTAT TIMER 10MI 115V               | \$1,694.58 |
| 10072                 | AGASTAT TIMER 30MI 115V*              | \$1,694.58 |
| 10069                 | AGASTAT SOCKET BASE*                  | \$17.88    |
| 13039                 | FUSE HOLDER                           | \$17.19    |
| 10032                 | (8) TERMINAL BLOCKS/1 END CAP*        | \$52.45    |
| 10035                 | START SWITCH                          | \$21.33    |
| 10036                 | STOP SWITCH                           | \$82.14    |
| 10038                 | PUSH BUTTON OPERATOR FOR START & STOP | \$64.29    |
| 10283                 | DPDT RELAY 120V AC                    | \$50.15    |

**\* ITEM NOT STOCKED, ALLOW FOUR WEEKS FOR DELIVERY**

**UV MODULE PARTS**

| Gaylord Part # | Description                   |          |
|----------------|-------------------------------|----------|
| 19312          | UV LIGHT GROMMET PACK OF 2    | \$14.05  |
| 19296          | UV LAMP 3 FOOT - BI-PIN       | \$164.53 |
| 19301          | UV LAMP 5 FOOT - BI-PIN       | \$231.78 |
| 20269          | UVi LAMP 3 FOOT - SINGLE PIN  | \$164.53 |
| 20270          | UVi LAMP 5 FOOT - SINGLE PIN  | \$231.78 |
| 19313          | UV LAMP HOLDER PACK OF 6      | \$14.05  |
| 20271          | LED UVI LAMP MONITORING BOARD | \$337.15 |
| 19799          | UV LIGHT SOCKET SINGLE PIN    | \$42.31  |

**UV MODULE PARTS**

| Gaylord Part # | Description   |            |
|----------------|---|------------|
| 20140          | 1/4" BONDED WASHER  | \$14.47    |
| 19356          | 1/4"-20 X 2- 1/2" BOLT PACK OF 10                                   | \$14.47    |
| 19358          | 1/4 RETAINING CLIP PACK OF 10                                       | \$14.47    |
| 20305          | 5' UV LIGHT BALLAST 115V CG3, GX2, XG HOOD MODELS                   | \$1,120.28 |
| 19308          | CIRCUIT BOARD STAND OFF (PACK OF 10)                                | \$14.05    |
| 18153          | FUSE (F1) 500M AMP UV CONTROLLER (PACK OF 5)                        | \$14.05    |
| 75878          | UV-3 GASKET KIT, INCLUDES: FRAME GASKET, LEFT & RIGHT CHASE GASKETS | \$217.22   |
| 22472          | UNIVERSAL UVI LIGHT BALLAST DUAL VOLTAGE ELX & ELXC                 | \$1,120.28 |
| 20993          | CG3-UV HOOD TO MODULE HARNESS                                       | \$14.72    |

**UV MODULE PARTS**

| Gaylord Part # | Description   |            |
|----------------|---|------------|
| 75879          | UV-5 GASKET KIT INCLUDES: FRAME GASKET, LEFT & RIGHT GASKETS FOR END CAPS               | \$476.57   |
| 76057          | ELX UVI-3 LIGHT MODULE (COMPLETE) INCLUDES UV LAMP HARNESS FRAME GASKETS                | \$1,965.87 |
| 76058          | ELX UVI-5 LIGHT MODULE (COMPLETE) INCLUDES UV LAMP HARNESS FRAME GASKETS                | \$2,121.94 |
| 75876          | UVi-3 LIGHT MODULE (COMPLETE) INCLUDES CONTROLLER BALLAST UV LAMP HARNESS FRAME GASKETS | \$7,445.24 |
| 75877          | UVi-5 LIGHT MODULE (COMPLETE) INCLUDES CONTROLLER BALLAST UV LAMP HARNESS FRAME GASKETS | \$7,756.65 |

| UV VENTILATOR PARTS |   | PAGE 14    |
|---------------------|---|------------|
| Gaylord Part #      | Description   |            |
| 76028               | 120volt UV MONITORING BOARD (CIRCUIT BOARD STYLE CONTROL)               | \$1,835.53 |
| 76029               | 220volt UV MONITORING BOARD (CIRCUIT BOARD STYLE CONTROL)               | \$1,835.53 |
| 19794               | UV GRAY DOOR GASKET STRIP ( 2 ROLLS FOR 3FT DOOR, 3 ROLLS FOR 4FT DOOR) | \$51.14    |
| 30529               | CONTACTOR   | \$307.46   |
| 11399               | CONTROL RELAY-SPDT  | \$47.38    |
| 11413               | SOCKET SPDT   | \$30.74    |
| 10283               | CONTROL RELAY-DPDT  | \$50.15    |
| 10295               | SOCKET-DPDT   | \$31.76    |
| 12512               | INDICATOR LIGHT - GREEN   | \$32.78    |
| 22692               | LINE FILTER   | \$417.42   |
| 11347               | TIME DELAY RELAY  | \$132.05   |
| 76087               | HIGH TEMP SHUTDOWN KIT  | \$245.44   |
| 22472               | UNIVERSAN UVI LIGHT BALLAST DUAL VOLTAGE ELX & ELXC                     | \$1,120.28 |
| 76076               | UV BALLAST PLATE INCLUDES 3 22472 BALLASTS AND WIRING HARNESS           | \$3,441.71 |

| UV VENTILATOR PARTS |   |          |
|---------------------|---|----------|
| Gaylord Part #      | Description   |          |
| 19162               | INDICATOR LIGHT - YELLOW                                | \$25.33  |
| 12510               | INDICATOR LIGHT - RED                                   | \$20.04  |
| 19355               | UV ACCESS DOOR SWITCH                                   | \$14.47  |
| 19365               | UV PRESSURE SWITCH FOR CG3, GX2, & XG MODEL VENTILATORS | \$228.17 |
| 20489               | UV PRESSURE SWITCH FOR ELX & ELXC MODEL VENTILATORS     | \$98.08  |
| 19350               | STATIC PRESSURE SWITCH                                  | \$42.25  |
| 19416               | UV PROXIMITY SWITCH (CG3)                               | \$486.73 |
| 19725               | ELX-UVi & ELXC-Uvi STATUS LIGHT GREEN                   | \$67.01  |
| 19724               | ELX-UVi & ELXC-Uvi STATUS LIGHT AMBER                   | \$67.01  |
| 20766               | ELX-UVi & ELXC-Uvi STATUS LIGHT BLUE                    | \$67.01  |

| UV VENTILATOR PARTS                     |   |          |
|---|---|----------|
| NON STOCK ITEMS. ALLOW 3 WEEKS TO SHIP. |   |          |
| Gaylord Part #                          | Description   |          |
| 19417                                   | PROXIMITY SWITCH MAGNET (CG3)   | \$161.54 |
| 16903                                   | UV PLUG FEMALE  | \$14.47  |
| 19430                                   | COOLING FAN   | \$80.23  |
| 19397                                   | UV STATUS LABEL   | \$49.62  |
| 19164                                   | UV HOUR METER 120VOLT   | \$364.51 |
| 20564                                   | HOUR METER  | \$365.13 |
| 21966                                   | CR24 RELAY FOR CONVERTING 120V SIGNAL TO DRY CONTACT FOR USE WITH 19164 | \$53.75  |

| UV VENTILATOR PARTS |  |         |
|---------------------|--|---------|
| Gaylord Part #      | Description  |         |
| 19400               | UV "CAUTION" LABEL   | \$59.47 |
| 19353               | GX2-UV-16-16" PARTICULATE SEPARATOR (STANDARD) 7 3/4" X 15 1/2"      | \$41.74 |
| 19354               | GX2-UV-20-20" PARTICULATE SEPARATOR (STANDARD) 7 3/4" X 19 1/2"      | \$45.72 |
| 19380               | GX2-UV-EN16-16" PARTICULATE SEPARATOR (ENLARGED) 8 7/16" X 15 1/2"   | \$42.47 |
| 19381               | GX2-UV-EN-20 -20" PARTICULATE SEPARATOR (ENLARGED) 8 7/16" X 19 1/2" | \$47.90 |
| 19522               | CG3 UV 16 PARTICULATE SEPARATOR (STANDARD) 7 5/8" X 15 1/2"          | \$41.01 |
| 19523               | CG3 UV 20 PARTICULATE SEPARATOR (STANDARD) 7 5/8" X 19 1/2"          | \$47.02 |
| 19451               | CG3 UV EN 16 PARTICULATE SEPARATOR (ENLARGED) 11 1/2" x 15 1/2"      | \$50.57 |
| 19452               | CG3 UV EN 20 PARTICULATE SEPARATOR (ENLARGED) 11 1/2" x 19 1/2"      | \$52.45 |

| CUV-1000 CONTROL FOR NON-WATER WASH SYSTEMS |  |            |
|---|--|------------|
| Gaylord Part #                              | Description                              |            |
| 20109                                       | CUV-1000 OPERATOR INTERFACE WITH PROGRAM | \$1,315.00 |
| 20108                                       | CUV-1000 PLC WITH PROGRAM                | \$1,075.00 |
| 20107                                       | CUV-1000/FM-1000 CABLE                   | \$95.00    |

**QUENCHER NOZZLES**

PAGE 15

| Gaylord Part # | Description                       |                            |            |
|----------------|-----------------------------------|----------------------------|------------|
| 19046          | DUAL TECH NOZZLES **              | ***NO DISCOUNTS ALLOWED*** | \$1,393.37 |
| 75888          | DUAL TECH BELL REDUCER NIPPLE KIT |                            | \$20.60    |

**QUENCHER FIRE PROTECTION CABINET**

\*\*\* CONSULT FACTORY FOR PRICING. ALLOW 3 WEEKS FOR FABRICATION \*\*\*

**QUENCHER NOZZLES - \*\*\*NO DISCOUNTS APPLY\*\*\***

| Gaylord Part # | Description  |                            |          |
|----------------|--|----------------------------|----------|
| 10285          | 175 DEGREE WATER SPRAY NOZZLE (YELLOW)                 | ***NO DISCOUNTS ALLOWED*** | \$750.47 |
| 10286          | 250 DEGREE WATER SPRAY NOZZLE (BLUE)                   | ***NO DISCOUNTS ALLOWED*** | \$750.47 |
| 10287          | 325 DEGREE WATER SPRAY NOZZLE (PURPLE)                 | ***NO DISCOUNTS ALLOWED*** | \$750.47 |
| 10289          | 500 DEGREE, 160° SPRAY ANGLE, ¼" ORIFICE, BRONZE       | ***NO DISCOUNTS ALLOWED*** | \$976.98 |
| 10290          | 500 DEGREE, 95° SPRAY ANGLE WATER SPRAY NOZZLE, BRONZE | ***NO DISCOUNTS ALLOWED*** | \$685.02 |
| 16401          | 325 DEGREE, 65° SPRAY ANGLE, ¼" ORIFICE, BRONZE (DUCT) | ***NO DISCOUNTS ALLOWED*** | \$544.50 |

**QUENCHER NOZZLES - \*\*\*\*NO DISCOUNTS APPLY\*\*\*\***

| Gaylord Part # | Description   |                           |          |
|----------------|---|---------------------------|----------|
| 16402          | 325 DEGREE, 160° SPRAY ANGLE, ¼" ORIFICE, BRONZE (PLENUM) | ***NO DISCOUNTS ALLOWED** | \$544.50 |
| 12832          | NOZZLE WRENCH   |                           | \$21.53  |
| 10278          | CHROME HEAD GUARD FOR NOZZLES                             |                           | \$68.81  |

**QUENCHER LINE STRAINERS**

| Gaylord Part # | Description        |  |          |
|----------------|--------------------|--|----------|
| 10149          | 1" LINE STRAINER   |  | \$73.95  |
| 10148          | 1 ¼" LINE STRAINER |  | \$98.62  |
| 10147          | 1 ½" LINE STRAINER |  | \$121.76 |
| 10152          | 2" LINE STRAINER   |  | \$221.93 |

**QUENCHER HOOD PENETRATION FITTINGS**

| Gaylord Part # | Description                                  |  |         |
|----------------|--|--|---------|
| 11337          | 3/8" HOOD PENETRATION FITTING WITH LOCKNUT   |  | \$37.04 |
| 11338          | ½" HOOD PENETRATION FITTING WITH LOCKNUT     |  | \$72.35 |
| 11339          | ½" EMT HOOD PENETRATION FITTING WITH LOCKNUT |  | \$45.46 |
| 11340          | 1" HOOD PENETRATION FITTING WITH LOCKNUT     |  | \$81.38 |

**QUENCHER MODEL "QUA" ELECTRICAL COMPONENTS**

PAGE 16

**NEW STYLE QUENCHER CONTROL**

| <b>Gaylord Part #</b> | <b>Description</b>                           |            |
|-----------------------|--|------------|
| 13178                 | QUENCHER TERMINAL BLOCK BOARD                | \$424.59   |
| 12836                 | QUENCHER QUA COMPLETE CONTROL                | \$3,252.89 |
| 11392                 | QUENCHER PC BOARD (NO BRACKET)               | \$2,297.43 |
| 10039                 | 4 AMP 250V SMALL DIM FUSE (PACK OF 5)        | \$15.25    |
| 13179                 | FLASHGUARD FOR QUENCHER TERMINAL BLOCK BOARD | \$43.33    |
| 13181                 | MYLAR DOOR LABEL FOR QUA SERIES              | \$69.32    |
| 15118                 | 1/4" X 7/8" OD PORON DISC W/ PSA (PACK OF 2) | \$22.77    |
| 11288                 | SPRING FOR QUENCHER (PACK OF 10)             | \$12.26    |
| 10283                 | DPDT RELAY 120V                              | \$50.15    |
| 11403                 | 3PDT RELAY 120V                              | \$62.14    |
| 19180                 | SPST MEMBRANE (FOR RESET BUTTON)             | \$181.30   |

**QUENCHER MODEL "QUS" SERIES ELECTRICAL COMPONENTS**

| <b>Gaylord Part #</b> | <b>Description</b>   |            |
|-----------------------|--|------------|
| 10039                 | 4 AMP 250V SMALL DIM FUSE (PACK OF 10)                       | \$15.25    |
| 75328                 | QUS RETRO-FIT COMPLETE CONTROL (SPECIFY HORIZ OR VERT MOUNT) | \$3,252.89 |
| 50453                 | POWER INTERRUPTION DEVICE Includes time delay relay          | \$1,242.00 |
| 10854                 | QUENCHER BATTERY   | \$100.05   |
| 10037                 | BY-PASS SWITCH   | \$26.12    |

**QUENCHER MODEL "QU" SERIES ELECTRICAL COMPONENTS**

| <b>Gaylord Part #</b> | <b>Description</b>                                   |          |
|-----------------------|--|----------|
| 12785                 | SYSTEM OPERATIONAL GREEN LIGHT                       | \$214.91 |
| 12783                 | SYSTEM NON OPERATIONAL AMBER LIGHT                   | \$239.88 |
| 12782                 | FIRE ALERT INDICATOR RED LIGHT                       | \$239.39 |
| 12784                 | RED RESET BUTTON                                     | \$267.39 |
| 10051                 | OPERATOR BASE W/SHROUD                               | \$70.51  |
| 10052                 | AMBER "BY-PASS" LENS WITH "BY-PASS" INSCRIPTION DISK | \$23.53  |
| 10053                 | GREEN BLANK LENS WITH "START" INSCRIPTION DISK       | \$30.30  |
| 10054                 | RED BLANK LENS WITH "STOP" INSCRIPTION DISK          | \$23.53  |
| 10055                 | RED RESET LENS                                       | \$23.53  |
| 10058                 | BLANK INSCRIPTION LENS ONLY (PACK OF 5)              | \$27.28  |

**QUENCHER MODEL "QU" ELECTRICAL COMPONENTS**

| <b>Gaylord Part #</b> | <b>Description</b>     |         |
|-----------------------|------------------------|---------|
| 10057                 | 6V BULB                | \$20.46 |
| 10062                 | LAMP HOLDER (SHORT)    | \$14.54 |
| 10064                 | TRANSFORMER 120V/6V    | \$89.34 |
| 10283                 | DPDT RELAY 120V        | \$50.15 |
| 10037                 | BY-PASS SWITCH         | \$26.12 |
| 10295                 | DPDT RELAY SOCKET BASE | \$31.76 |
| 11403                 | 3 PDT RELAY 120V       | \$62.14 |

**\* ITEM NOT STOCKED, ALLOW TWO WEEKS FOR DELIVERY**



**QUENCHER PLUMBING COMPONENTS**

PAGE 17

| <b>Gaylord Part #</b> | <b>Description</b>                 |          |
|-----------------------|------------------------------------|----------|
| 11383                 | PRESSURE SWITCH (POTTER)           | \$625.70 |
| 11465                 | 1" TO 1 1/2" FLOW SWITCH (POTTER)  | \$542.58 |
| 11466                 | 2" FLOW SWITCH (POTTER)            | \$828.78 |
| 10277                 | PRESSURE GAUGE TYPE 35 (0-300 PSI) | \$75.09  |
| 15856                 | QUENCHER PRESSURE HOSE ASSEMBLY    | \$925.42 |
| 10171                 | 1" BUTTERFLY VALVE                 | \$552.53 |
| 10172                 | 1-1/4" BUTTERFLY VALVE             | \$585.97 |
| 10173                 | 1-1/2" BUTTERFLY VALVE             | \$703.06 |
| 10174                 | 2" BUTTERFLY VALVE                 | \$846.48 |

**QUENCHER CHROME FITTINGS**

| <b>Gaylord Part #</b> | <b>Description</b>            |          |
|-----------------------|-------------------------------|----------|
| 15854                 | 1" 45 DEGREE CHROME ELBOW     | \$23.90  |
| 10551                 | 1" 90 DEGREE CHROME ELBOW     | \$21.18  |
| 10573                 | 1" CHROME TEE                 | \$26.76  |
| 10582                 | 1" CHROME UNION               | \$83.78  |
| 10592                 | 1" X 1/2" CHROME BELL REDUCER | \$22.37  |
| 10589                 | 1" X 1/2" CHROME REDUCING 90  | \$22.37  |
| 10651                 | 1" CHROME COUPLER             | \$23.90  |
| 10642                 | 1" CHROME SLEEVING, 6' STICK  | \$146.13 |

**GAS SOLENOID VALVES**

PAGE 18

| <b>Gaylord Part #</b> | <b>Description</b>      |            |
|-----------------------|-------------------------|------------|
| 10212                 | 1" GAS SOLENOID VALVE   | \$813.83   |
| 10213                 | 1 ¼" GAS SOLENOID VALVE | \$811.94   |
| 10214                 | 1 ½" GAS SOLENOID VALVE | \$937.32   |
| 10215                 | 2" GAS SOLENOID VALVE   | \$1,361.20 |
| 10211                 | 2 ½" GAS SOLENOID VALVE | \$1,883.59 |
| 10210                 | 3" GAS SOLENOID VALVE   | \$2,411.95 |

**\* ITEM NOT STOCKED, ALLOW TWO WEEKS FOR DELIVERY****GAS SOLENOID VALVE REPAIR KITS**

| <b>Gaylord Part #</b> | <b>Description</b>                             |            |
|-----------------------|--|------------|
| 10201                 | ¾" GAS SOLENOID VALVE REPAIR KIT *             | \$368.55   |
| 10204                 | 1 1/4" -1 1/2" GAS SOLENOID VALVE REPAIR KIT * | \$799.58   |
| 10205                 | 2" GAS SOLENOID VALVE REPAIR KIT *             | \$959.49   |
| 10206                 | 2 ½" GAS SOLENOID VALVE REPAIR KIT *           | \$1,312.26 |
| 10207                 | 3" GAS SOLENOID VALVE REPAIR KIT *             | \$2,178.87 |

**\* ITEM NOT STOCKED, ALLOW TWO WEEKS FOR DELIVERY****GAS SOLENOID VALVE COILS**

| <b>Gaylord Part #</b> | <b>Description</b>                        |          |
|-----------------------|---|----------|
| 10208                 | 120V COIL FOR ½" & ¾" GAS SOLENOID VALVE* | \$182.09 |
| 10219                 | 120V COIL FOR 1" & UP GAS SOLENOID VALVE* | \$286.90 |

**\* ITEM NOT STOCKED, ALLOW TWO WEEKS FOR DELIVERY**

**VENTILATOR COMPONENT PARTS**

PAGE 19

| <b>Gaylord Part #</b> | <b>Description</b>                     |          |
|-----------------------|--|----------|
| 10905                 | GREASE CUP 6" X 3 1/4" X 2"            | \$34.36  |
| 75584                 | CHROME "T" DOOR HANDLE WITH TONGUE KIT | \$29.73  |
| 76042                 | ELX APRON STYLE GREASE CUP             | \$113.21 |
| 76040                 | ELX CAPTURE WALL STYLE GREASE CUP      | \$113.21 |

**VENTILATOR, HRU AND RSPC SPRAY NOZZLES**

| <b>Gaylord Part #</b> | <b>Description</b>                                   |          |
|-----------------------|--|----------|
| 10303                 | SINGLE HEAD SPRAY NOZZLE FOR VENTILATORS (PACK OF 2) | \$29.08  |
| 10304                 | DUAL HEAD SPRAY NOZZLE FOR VENTILATORS               | \$153.39 |
| 10305                 | HIGH VOLUME SPRAY NOZZLE FOR VENTILATORS*            | \$70.24  |
| 15330                 | MIST JET SPRAY NOZZLE FOR CM VENTILATORS*            | \$53.39  |
| 10306                 | SPRAY NOZZLE FOR HRU (BRASS)*                        | \$82.18  |
| 10301                 | SPRAY NOZZLE FOR SPC/RSPC*                           | \$32.20  |
| 19717                 | RSPC-ESP OCCOLATING WASH NOZZLE                      | \$24.10  |
| 20329                 | ELXC HIGH VOLUME, WIDE SPRAY EXTRACTOR NOZZLE        | \$31.17  |

**VENTILATOR THERMOSTATS**

| Gaylord Part # | Description  |          |
|----------------|--|----------|
| 10102          | 6" NO THERMOSTAT, 350°                                       | \$468.82 |
| 10103          | 12" NO THERMOSTAT, 350°, FOR CG                              | \$386.36 |
| 16824          | 6" NC THERMOSTAT, 200°, FOR FX *                             | \$500.39 |
| 18806          | 6" NC THERMOSTAT, 250°, FOR GX2                              | \$677.38 |
| 18465          | 12" NC THERMOSTAT, 250°, FOR GX2                             | \$515.94 |
| 18781          | 12" NO COUPLING THERMOSTAT, 250°, FOR CG3 MFG AFTER 7/1/01   | \$513.81 |
| 18466          | 15" NC THERMOSTAT, 250°, FOR GX2                             | \$474.64 |
| 18782          | 15" NO COUPLING THERMOSTAT, 250°, FOR CG3 MFG AFTER 7/1/01 * | \$500.31 |

**\* ITEM NOT STOCKED, ALLOW TEN WEEKS FOR DELIVERY**

**VENTILATOR THERMOSTATS**

| Gaylord Part # | Description                                     |            |
|----------------|---|------------|
| 11928          | 6" NC THERMOSTAT, 280°, FOR RG AND GX *         | \$500.39   |
| 11930          | 6" NC THERMOSTAT, 350°, FOR CG *                | \$500.39   |
| 15656          | 12" NO THERMOSTAT, 280°, FOR RG AND GX          | \$398.72   |
| 15657          | 12" NO THERMOSTAT, 350°, FOR CG                 | \$410.69   |
| 10104          | NAVY FAIL-SAFE THERMOSTAT 2 WIRE, 440V          | \$1,981.98 |
| 10105          | NAVY FAIL-SAFE THERMOSTAT 3 WIRE, 115V OR 220V* | \$2,319.87 |
| 19816          | NAVY FAIL-SAFE THERMOSTAT 4 WIRE, 440V*         | \$2,529.51 |
| 11325          | NAVY THERMOSTAT MOUNTING PLATE                  | \$103.76   |

**NO=NORMALLY OPEN CONTACT**

**NC=NORMALLY CLOSED CONTACT**

**\* ITEM NOT STOCKED, ALLOW TEN WEEKS FOR DELIVERY**

**FUSELINKS**

| Gaylord Part # | Description                             |         |
|----------------|---|---------|
| 10321          | 165° TYPE ML FUSE LINK MA (MAKE UP AIR) | \$18.51 |
| 10322          | 212° TYPE ML FUSE LINK FILTERHOODS      | \$21.18 |
| 10323          | 280° TYPE ML FUSE LINK GX OR RG         | \$18.51 |

**MI CABLE WITH FITTINGS ATTACHED****PARTS NOT STOCKED. ALLOW 6 WEEKS FOR DELIVERY**

| Gaylord Part # | Description                                 |          |
|----------------|---|----------|
| 15812          | 2 WIRE MI CABLE 24" FROM FITTING TO FITTING | \$299.48 |
| 15814          | 2 WIRE MI CABLE 30" FROM FITTING TO FITTING | \$307.24 |
| 15813          | 2 WIRE MI CABLE 60" FROM FITTING TO FITTING | \$382.97 |
| 19191          | 4 WIRE MI CABLE 24" FROM FITTING TO FITTING | \$311.72 |
| 19192          | 4 WIRE MI CABLE 30" FROM FITTING TO FITTING | \$314.44 |
| 19193          | 4 WIRE MI CABLE 60" FROM FITTING TO FITTING | \$418.38 |

**MI CABLE COMPONENTS**

| Gaylord Part # | Description                                      |          |
|----------------|--|----------|
| 10106          | 2 WIRE CONDUCTOR MI CABLE (PRICE/FT.)            | \$32.20  |
| 15815          | 4 WIRE CONDUCTOR MI CABLE (PRICE/FT)             | \$56.58  |
| 10108          | 2 WIRE TERMINATION KIT (2 FITTINGS) FOR MI CABLE | \$173.95 |
| 14943          | 4 WIRE TERMINATION KIT (2 FITTINGS) FOR MI CABLE | \$240.29 |
| 10110          | SEALING RING FOR MI CABLE (PACK OF 5)            | \$27.11  |

**START/STOP SWITCH FOR NON WATER-WASH VENTILATORS****C-250 FAN ON/OFF SWITCH IS NO LONGER AVAILABLE****FIRE SWITCHES**

| Gaylord Part # | Description  |            |
|----------------|--|------------|
| 10100          | 2 WIRE TOGGLE SWITCH FOR C-1357A   | \$165.08   |
| 10098          | RED FIRE SWITCH – COMMERCIAL OR NAVY (YELLOW SWITCH DISCONTINUED)                | \$494.91   |
| 21825          | RED FIRE SWITCH – NAVY 440V 6-8 WEEK LEAD-TIME <b>***NO DISCOUNTS ALLOWED***</b> | \$3,533.65 |
| 10096          | 3 WIRE TOGGLE SWITCH (MARINE APPLICATION)  | \$205.76   |
| 10099          | REPLACEMENT GLASS ROD FOR FIRE SWITCH (PACK OF 10)                               | \$176.88   |

| Gaylord Part #                 | Description                |          |
|--------------------------------|----------------------------|----------|
| <b>BURGER KING VENTILATORS</b> |                            |          |
| 17193                          | FRYER COMPUTER COVER       | \$64.22  |
| 90159                          | BROILER GREASE DRAWER      | \$113.20 |
| 18249                          | LEFT HAND BULLET HINGE     | \$58.26  |
| 18231                          | RIGHT HAND BULLET HINGE    | \$58.26  |
| 19009                          | HEAT SHIELD FRICTION HINGE | \$59.68  |
| <b>WHATABURGER VENTILATORS</b> |                            |          |
| 19641                          | SNAP DISK LIMIT CONTROL    | \$105.09 |
| 19584                          | HEATER STRIP               | \$187.41 |

**GX EXTRACTOR INSERTS**

Determine if you need a GX or GX-DS style. Measure the distance between the handle and the cartridge.

GX will be 5" handle to cartridge, GX-DS will be 7" handle to cartridge.

| Gaylord Part # | Description   |          |
|----------------|---|----------|
| 12788          | GX 16B EXTRACTOR 250/GX-16B   | \$342.00 |
| 12789          | GX 20B EXTRACTOR250/GX-20B  | \$377.64 |
| 12790          | GX 16B EXTRACTOR FOR DS OR 400 SERIES VENTILATOR/GX-DS-16B            | \$384.08 |
| 12791          | GX 20B EXTRACTOR FOR DS OR 400 SERIES VENTILATOR/GX-DS-20B            | \$397.43 |
| 92095          | GX 16 EXTRACTOR FOR 150 CFM VENTILATOR/GX-16B-150                     | \$339.96 |
| 92090          | GX 20 EXTRACTOR FOR 150 CFM VENTILATOR/GX-20B-150                     | \$350.07 |
| 18380          | GX2 16 EXTRACTOR/GX2-16   | \$407.39 |
| 18385          | GX2 20 EXTRACTOR/GX2-20   | \$469.02 |
| 18390          | GX2 16 EXTRACTOR FOR DS OR 400 SERIES VENTILATOR – OLD STYLE/GX-DS-16 | \$453.11 |
| 18395          | GX2 20 EXTRACTOR FOR DS OR 400 SERIES VENTILATOR – OLD STYLE/GX-DS-20 | \$473.72 |
| 18745          | GX2 16 EXTRACTOR FOR DS OR 400 SERIES VENTILATOR/GX-EN-16             | \$434.72 |
| 18746          | GX2 20 EXTRACTOR FOR DS OR 400 SERIES VENTILATOR/GX-EN-20             | \$469.54 |

**GX EXTRACTOR INSERTS**

| Gaylord Part # | Description  |          |
|----------------|--|----------|
| 13215          | GX 16A EXTRACTOR - OLD STYLE/GX-16A                                    | \$412.02 |
| 13216          | GX 20A EXTRACTOR - OLD STYLE/GX-20A                                    | \$445.77 |
| 13217          | GX 16A EXTRACTOR FOR DS OR 400 SERIES VENTILATOR - OLD STYLE/GX-DS-16A | \$480.08 |
| 13218          | GX 20A EXTRACTOR FOR DS OR 400 SERIES VENTILATOR - OLD STYLE/GX-DS-20A | \$496.82 |
| 75890          | GX2-UV-16 EXTRACTOR/GX2-UV-16  | \$551.51 |
| 75891          | GX2-UV-20 EXTRACTOR/GX2-UV-20  | \$569.58 |
| 75896          | GX2-UV-EN-16 EXTRACTOR/GX2-UV-EN-16                                    | \$525.61 |
| 75897          | GX2-UV-EN-20 EXTRACTOR/GX2-UV-20                                       | \$595.63 |
| 18400          | GX & GX2 EXTRACTOR REMOVAL TOOL  | \$226.47 |
| 75587          | 4" PULL HANDLE KIT FOR GX INSERTS (PACK OF 2)                          | \$35.80  |

**PG, SG, EL HOOD FILTERS**

PAGE 23

| Gaylord Part # | Description                          |          |
|----------------|--------------------------------------|----------|
| 18995          | 10"H X 16"W TYPE 3 S/S GREASE FILTER | \$159.07 |
| 18996          | 10"H X 20"W TYPE 3 S/S GREASE FILTER | \$165.65 |
| 18997          | 12"H X 20"W TYPE 3 S/S GREASE FILTER | \$186.36 |
| 18998          | 16"H X 16"W TYPE 3 S/S GREASE FILTER | \$180.39 |
| 18999          | 16"H X 20"W TYPE 3 S/S GREASE FILTER | \$206.13 |
| 19000          | 20"H X 16"W TYPE 3 S/S GREASE FILTER | \$206.13 |
| 19001          | 20"H X 20"W TYPE 3 S/S GREASE FILTER | \$231.54 |
| 19002          | 25"H X 16"W TYPE 3 S/S GREASE FILTER | \$231.54 |
| 19003          | 25"H X 20"W TYPE 3 S/S GREASE FILTER | \$264.48 |

**PG, SG, EL STAINLESS STEEL FILTERS WITH SPARK ARRESTER**

| Gaylord Part # | Description  |          |
|----------------|--|----------|
| 18897          | 16"H X 20" W TYPE 1 S/S GREASE FILTER W/SPARK ARRESTER | \$491.44 |
| 18898          | 16"H X 16" W TYPE 1 S/S GREASE FILTER W/SPARK ARRESTER | \$483.41 |

**XG EXTRACTOR CARTIDGES**

| Gaylord Part # | Description                                      |          |
|----------------|--|----------|
| 75963          | 18Hx16W XG EXTRACTOR (OUT OF STOCK)              | \$405.12 |
| 75964          | 11Hx16W XG EXTRACTOR FOR BURGER KING VENTILATORS | \$376.19 |

**XGS EXTRACTOR CARTIDGES FOR ELC & ELXC MODEL HOODS**

| Gaylord Part # | Description                  |          |
|----------------|------------------------------|----------|
| 76044          | 11" XGS EXTRACTOR (STANDARD) | \$106.01 |
| 76042          | 18" XGS EXTRACTOR (ENLARGED) | \$179.69 |
| 76046          | XGS EXTRACTOR REMOVAL TOOL   | \$245.24 |

**HOOD LIGHTS**

| PARTS NOT STOCKED. LEAD TIME WILL VARY |  |            |
|--|--|------------|
| Gaylord Part #                         | Description  |            |
| 50432                                  | 2 FT RECESSED LIGHT COMPLETE (FLUORESCENT)                                   | \$721.20   |
| 19681                                  | 3 FT RECESSED LIGHT COMPLETE (FLUORESCENT)                                   | \$585.31   |
| 19651                                  | 4 FT RECESSED LIGHT COMPLETE (FLUORESCENT)                                   | \$632.32   |
| 20340                                  | 2 FT RECESSED LIGHT COMPLETE (LED)   | \$1,122.84 |
| 20341                                  | 3 FT RECESSED LIGHT COMPLETE (LED)   | \$1,505.55 |
| 20342                                  | 4 FT RECESSED LIGHT COMPLETE (LED)   | \$1,568.94 |
| 13211                                  | 12 X 12 LIGHT LENS AND RETAINER  | \$153.63   |
| 22514                                  | 2 FT LIGHT LENS AND RETAINER   | \$169.74   |
| 10111                                  | 3 FT LIGHT LENS AND RETAINER   | \$197.94   |
| 10112                                  | 4 FT LIGHT LENS AND RETAINER   | \$249.86   |
| 19623                                  | 12X12 RECESSED LIGHT COMPLETE (INCANDESCENT)                                 | \$458.51   |
| 23362                                  | RECESSED FLUORESCENT HARDWARE KIT ( INCLUDES 4 SCREWS, CAGE NUT, AND O'RING) | \$11.60    |

**HOOD LIGHTS**

| PARTS NOT STOCKED. LEAD TIME WILL VARY            |  |                                     |
|---|--|-------------------------------------|
| Gaylord Part #                                    | Description  |                                     |
| 13211   | 12 X 12 LIGHT LENS AND RETAINER                            | \$153.63                            |
| 22886   | LED PUCK LIGHT   | \$575.00                            |
| 22887   | LED PUCK LIGHT BASE  | \$125.00                            |
| 10119   | GLOBE FOR BULLET SHAPED 100 WATT LIGHT FIXTURE             | \$34.42                             |
| 10120   | LIGHT HOUSING FOR 100 WATT LIGHT                           | \$53.47                             |
| 11124   | WIRE GUARD FOR 100 WATT LIGHT GLOBE                        | \$27.60                             |
| 10121   | CLEAR GLOBE FOR CONE SHAPED FIXTURE (RIBBED)               | \$130.23                            |
| 10126   | BALLAST FOR FLUORESCENT FIXTURE (DOES NOT INCLUDE SOCKETS) | \$222.53                            |
| <b>**NO DISCOUNT APPLIES ON LED LIGHT TUBES**</b> |  |                                     |
| 20614   | 4' LED LIGHT TUBE**  | ***NO DISCOUNTS ALLOWED*** \$254.95 |
| 20613   | 3' LED LIGHT TUBE**  | ***NO DISCOUNTS ALLOWED*** \$248.73 |
| 20612   | 2' LED LIGHT TUBE**  | ***NO DISCOUNTS ALLOWED*** \$185.41 |



## RSPC-TPF/ESP AND SPC COMPONENT PARTS

| Gaylord Part # | Description                                    |            |
|----------------|--|------------|
| 12301          | RSPC DOOR LATCH                                | \$18.97    |
| 76131          | 24" HORIZONTAL OUTER CELL FOR RSPC *           | \$3,936.02 |
| 76132          | 24" HORIZONTAL INNER CELL FOR RSPC*            | \$4,077.11 |
| 12801          | SOAK TANK FOR 24" CELL *                       | \$1,265.59 |
| 16514          | RSPC 3-4 CELL POWER SUPPLY (4 CELLS)           | \$1,797.13 |
| 20605          | 18 GA HIGH VOLTAGE CABLE (PER FOOT)            | \$4.98     |
| 10332          | TERMINAL CLIP COVER FOR CELLS, 90° RUBBER BOOT | \$16.13    |
| 10335          | SPARK PLUG, TERMINAL (10 PER PACK)             | \$23.15    |
| 10338          | IONIZING WIRE TYPE C                           | \$30.15    |
| 11301          | DOUBLE CELL SPRING CONNECTOR (5 PER PACK)      | \$69.09    |
| 18785          | RSPC METER RETRO FIT                           | \$92.09    |
| 19041          | DOOR PLUNGER SAFETY SWITCH FOR SPC             | \$305.28   |
| 12798          | DOOR PLUNGER SAFETY SWITCH RSPC                | \$305.28   |
| 22417          | ESP INSULATOR PAD                              | \$19.84    |
| 19700          | OSOLATING WASH MOTOR (RSPC)                    | \$956.95   |
| 19716          | 1/2" SWIVEL ELBOW                              | \$332.80   |
| 19715          | 1/2" LIVE SWIVEL STRAIGHT                      | \$309.90   |

**RSPC-TPF FILTERS**

\*\*\*NO DISCOUNTS ALLOWED\*\*\*

**Contact Service Agent****Gaylord Part # Description**

|       |   |          |
|-------|---|----------|
| 30074 | 24X24X4 CLI PLEATED PRE-FILTER (TPF)                                  | \$69.48  |
| 30241 | 24X24X22 6 POCKET 95% BAG FILTER (TPF) <b>**(30514 REPLACEMENT)**</b> | \$79.06  |
| 30515 | DOP 95% FILTER 24X24X12 FINAL FILTER (TPF)                            | \$292.12 |

**ESP FILTERS****Contact Service Agent****Gaylord Part # Description**

|       |                            |          |
|-------|----------------------------|----------|
| 30167 | DEBRIS SCREEN 24X24X2      | \$78.30  |
| 20006 | XGS IMPACTOR 24"x24"x2"    | \$517.50 |
| 30080 | MOISTURE SEPARATOR 24X24X4 | \$298.08 |

**ODOR CONTROL FILTERS****Contact Service Agent****Gaylord Part # Description**

|       |   |          |
|-------|---|----------|
| 30905 | SINGLE PASS ODOR 24X6X18 (replaces part number 30643) | \$194.00 |
| 30906 | SINGLE PASS ODOR REPLACEMENT PANELS (PACK OF 2)       | \$192.00 |
| 30913 | MEDIA TESTER  | \$75.00  |

**RSPC FM-100 MONITORING PANEL PARTS**

| Gaylord Part # | Description                                 |          |
|----------------|---|----------|
| 19038          | CLEAN AIR FM-100 CONTROL LABEL              | \$77.46  |
| 19317          | INDICATOR LIGHT - GREEN                     | \$18.50  |
| 18178          | CLEAR NEON INDICATOR LIGHT 125V (PACK OF 2) | \$25.47  |
| 19318          | INDICATOR LIGHT - RED                       | \$12.58  |
| 11119          | LIFT & TURN COMPRESSION LATCH               | \$132.68 |
| 19076          | FM-100 CANCEL SWITCH                        | \$222.98 |
| 18644          | C-150 SWITCH LABEL                          | \$14.47  |
| 19154          | LOW ODOR CONTROL CHEM. LABEL                | \$77.53  |
| 17061          | FUSE - MAIN                                 | \$14.47  |
| 11403          | CONTROL RELAYCR1                            | \$62.14  |
| 11418          | SOCKET CR1                                  | \$31.64  |
| 10283          | CONTROL RELAY R3                            | \$50.15  |
| 10295          | SOCKET CR3                                  | \$31.76  |
| 11399          | CONTROL RELAY CR4                           | \$47.38  |
| 11413          | SOCKET CR4                                  | \$30.74  |
| 30375          | TIMING RELAY ON DELAY DPT TR1               | \$317.81 |
| 19272          | SOCKET 8-PIN                                | \$22.80  |
| 19319          | SONALERT                                    | \$154.42 |

**RSPC FM-1000 MONITORING STATION PARTS**

|       |   |            |
|-------|---|------------|
| 20111 | FM-1000 OPERATOR INTERFACE WITH PROGRAM | \$1,150.00 |
| 20110 | FM-1000 PLC WITH PROGRAM                | \$1,140.00 |
| 20107 | FM-1000 CABLE                           | \$95.00    |

**ODOR CONTROL PARTS (SPRAY TYPE)**

PARTS NOT STOCKED. LEAD TIME WILL VARY

| Gaylord Part # | Description                                   |            |
|----------------|---|------------|
| 19119          | SPRAY ODOR CABINET ASSEMBLY (25"X25")         | \$7,218.72 |
| 10272          | 1/4" I.D. FLEXIBLE SUCTION TUBE SOLD PER FOOT | \$2.55     |
| 19065          | SPRAY NOZZLE ASSEMBLY                         | \$2,163.92 |
| 11000          | 3/8" COPPER TUBING                            | \$14.47    |
| 19073          | CYCLE AND SPRAY TIMER RELAY                   | \$402.53   |
| 10276          | PRESSURE GAUGE                                | \$75.55    |
| 19070          | NEEDLE VALVE                                  | \$70.64    |
| 19072          | AIR COMPRESSOR                                | \$1,324.37 |
| 19075          | HEATER  | \$969.50   |
| 19097          | 5 GALLON CONTAINER OF GS-710                  | \$91.31    |
| 19071          | LEVEL SENSOR FOR SPRAY ODOR CH3EMICAL         | \$619.89   |
| 10269          | 1/4" FOOT VALVE (IN TANK)                     | \$56.00    |

**MYLAR FACEPLATE LABELS**

| Gaylord Part # | Description  |         |
|----------------|--|---------|
| 18899          | C-6000 MYLAR FACEPLATE   | \$77.05 |
| 18695          | C-5000-99 MYLAR FACEPLATE  | \$55.17 |
| 16907          | C-5000 MYLAR FACEPLATE   | \$66.23 |
| 15326          | C-4000 MYLAR FACEPLATE   | \$74.36 |
| 13181          | MODEL QUA SERIES MYLAR FACEPLATE (VERTICAL)  | \$69.32 |
| 13124          | MODEL QUS SERIES MYLAR FACEPLATE (HORIZONTAL)  | \$69.32 |
| 15118          | ¼" X 7/8" OD PORON DISC W/ PSA (PACK OF 2) (REQUIRED WHEN REPLACING MYLAR FACEPLATE) | \$22.77 |

**EXHAUST DAMPERS****ALLOW 6-8 WEEKS FOR FABRICATION**

| Gaylord Part # | Description                               |                                       |
|----------------|---|---------------------------------------|
| 12732          | AUXILIARY EXHAUST TERMINAL 440V*          | ***NO DISCOUNTS ALLOWED*** \$7,336.37 |
| 12749          | AUXILIARY EXHAUST TERMINAL 115V*          | ***NO DISCOUNTS ALLOWED*** \$6,955.33 |
| 18826          | AUXILIARY EXHAUST TERMINAL DE-SMOKE 440V* | ***NO DISCOUNTS ALLOWED*** \$6,829.11 |
| 18825          | AUXILIARY EXHAUST TERMINAL DE-SMOKE 115V* | ***NO DISCOUNTS ALLOWED*** \$6,829.11 |
| 12828          | REPAIR KIT FOR DE-SMOKE STATION           | \$623.76                              |
| 76001          | GED DIVERTING DAMPER                      | \$6,405.56                            |
| 12828          | REPAIR KIT FOR DE-SMOKE STATION           | \$623.76                              |

**\*SPECIFY HEIGHT, WIDTH AND THE DAMPER LOCATION USE APPENDIX SHEET A-18 FOR ORDERING.**

**AIR FLOW METERS**

| Gaylord Part # | Description                |            |
|----------------|----------------------------|------------|
| 13214          | DIGITAL ANEMOMETER         | \$2,193.46 |
| 18408          | DIGITAL ANEMOMETER BRACKET | \$41.12    |



Appendix A-18

|                |   |                      |   |   |    |                |        |
|----------------|---|----------------------|---|---|----|----------------|--------|
|                |   |                      |   |   |    |                |        |
| EXAMPLE        | 1 | NSD1-9-5-16-R-AL-440 | 9 | 5 | 16 | R              | SS 440 |
| Kitchen Area # |   | Model no.            | H | W | 16 | location Mat'l | Volt   |

PLAN VIEW

ELEVATION

TYPE 'L' CONTROL

PLAN VIEW

ELEVATION

TYPE 'R' CONTROL

PLAN VIEW

ELEVATION

TYPE 'R' CONTROL

PLAN VIEW

ELEVATION

TYPE 'RR' CONTROL

DAMPER CONTROL BOX LOCATION (SEE DETAILS AT LEFT FOR PROPER LOCATION)

DAMPER IN NORMAL CLOSED POSITION

1" x 1/8" FLANGE

16" STANDARD

19"

(H)

DAMPER IN NORMAL CLOSED POSITION

DAMPER OPENS WHEN ACTIVATED

DAMPER STOP

16

9.5

7

9

10.5

(H)

**TYPICAL GAYLORD AUXILIARY EXHAUST DE-SMOKE TERMINAL WITH SOLENOID OPERATED DAMPER**

MODEL: NSD1-(H)-(W)-16-(CONTROL LOCATION)-(MATERIAL)-VOLTAGE

**DETERGENT PUMP**  
**MODEL NUMBER VF-100P-60B**

| ITEM.                      | PART NUMBER |
|----------------------------|-------------|
| MOTOR COVER.....           | 10226       |
| ELECTRICAL "J" BOX.....    | N/A         |
| COVER MOUNTING SCREWS..... | N/A         |
| MOTOR MOUNTING SCREWS..... | N/A         |
| ARMATURE BEARING.....      | 10231       |
| COIL (115 VOLT).....       | 10232       |
| COIL (220 VOLT).....       | 10259       |
| ARMATURE.....              | 10233       |
| ARMATURE SPACER.....       | 10234       |
| GEAR BOX ASSEMBLY.....     | 10253       |
| BRACKET.....               | 10236       |
| SET SCREW.....             | 10237       |

| ITEM.                                       | PART NUMBER |
|---|-------------|
| YOKE AND BEARING ASSEMBLY.....              | 10237       |
| PUSH BUTTON TEST SWITCH.....                | 10238       |
| CAM #1.....                                 | 10254       |
| CAM #2.....                                 | 10255       |
| CAM #3.....                                 | 10256       |
| CAM #4.....                                 | 10257       |
| SCREWS FOUR REQUIRED.....                   | 10239       |
| DIAPHRAGM.....                              | 10240       |
| BRASS OUTLET.....                           | 10242       |
| TOP CAP.....                                | 10244       |
| SPRING.....                                 | 10246       |
| PUMP HEAD (Complete with all fittings)..... | 10247       |
| POPPET CHECK.....                           | 10250       |
| "O" RING.....                               | 10251       |
| COMPLETE PUMP HEAD/FOOT VALVE KIT.....      | 10275       |
| MOUNTING SCREW(Head)Four required.....      | 10248       |
| TUBE NUT (1/4").....                        | 10268       |
| ADAPTER WITH "O"RING.....                   | 10260       |
| BRASS DETERGENT INLET Check valve.....      | 10265       |
| SPRING.....                                 | 10266       |
| TUBE NUT.....                               | 10261       |
| FOOT VALVE(Complete).....                   | 10269       |
| ALLEN WRENCH(1/16").....                    | 10271       |
| VINYL TUBING.....                           | 10272       |
| COPPER TUBING(1/4").....                    | 10273       |

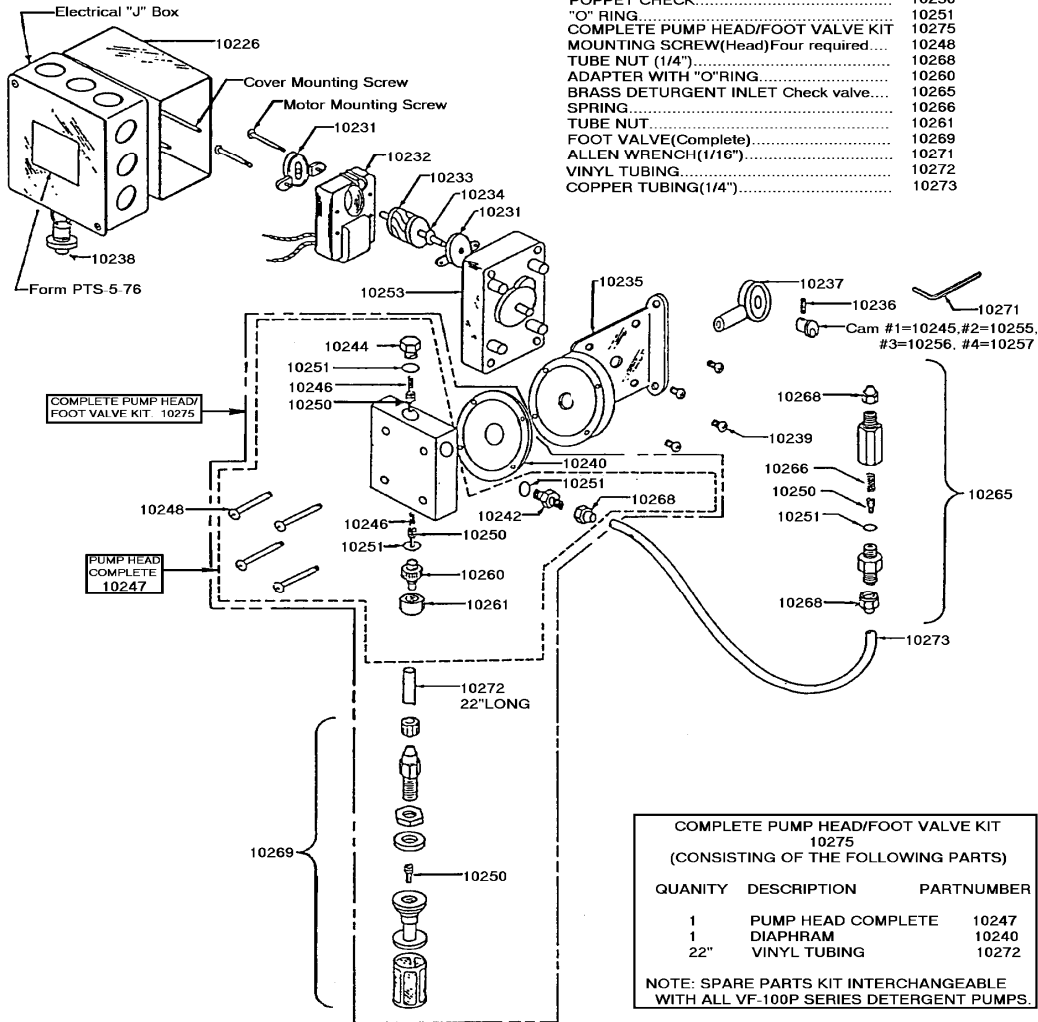

| COMPLETE PUMP HEAD/FOOT VALVE KIT<br>10275<br>(CONSISTING OF THE FOLLOWING PARTS) |                    |            |
|---|--------------------|------------|
| QUANTITY  | DESCRIPTION        | PARTNUMBER |
| 1   | PUMP HEAD COMPLETE | 10247      |
| 1   | DIAPHRAM           | 10240      |
| 22"   | VINYL TUBING       | 10272      |

NOTE: SPARE PARTS KIT INTERCHANGEABLE WITH ALL VF-100P SERIES DETERGENT PUMPS.



# GAYLORD INDUSTRIES, INC.

WORLD HEADQUARTERS: P.O. BOX 1149 • TUALATIN, OR 97062-1149 USA  
PHONE: (503) 691-2010 (800) 547-9596 • FAX: (503) 692-6048

## GX EXTRACTOR IDENTIFICATION SHEET

- 1- Measure and fill in the measurement for the height of the extractor opening.
- 2- Measure and fill in the measurement for the depth of the extractor.
- 3- Measure the length-wise cartridge opening \_\_\_\_\_.
- 4- Indicate whether extractor has clip style "A" or "B".
- 5- Approximate year the hood was built \_\_\_\_\_.

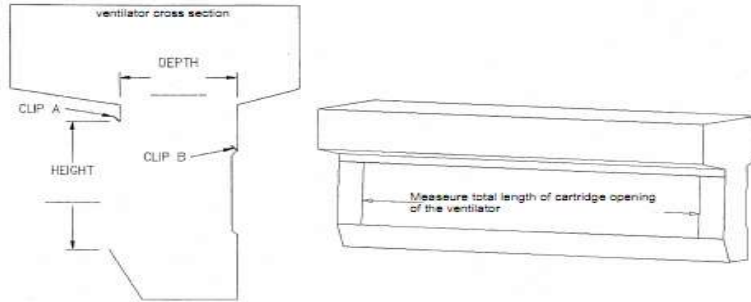

Depth = 7" = GX-400 or GX-400-DS  
Depth = 5" = GX-250  
Depth = 3" = GX-150

Height = 7 1/2" = GX-250  
Height = 10" = GX or GX-DS

Clip "A" = "A" style cartridge  
Clip "B" = "B" style cartridge

### Shipping Information:

Address: \_\_\_\_\_

\_\_\_\_\_

Phone No.: \_\_\_\_\_

### Payment Terms:

COD    Pre Pay    VISA / MASTERCARD

U:\Lsd\4fgx\_extractor\_id\_sheet.doc